

GENERAL SPECIFICATIONS FOR SB25, SB60s, SB200s

Electrical Capacity (Resistive Load)

Power Level: Shown in the following tables

Other Ratings

Contact Resistance:	10 milliohms maximum
Insulation Resistance:	200 megohms minimum @ 500V DC for SB220s, SB265s, SB285; 1,000 megohms minimum @ 500V DC for SB60s; 100 megohms minimum @ 500V DC for SB25s
Dielectric Strength:	1,500V AC minimum for SB265s, SB285, & SB25s for 1 minute minimum; 2,000V AC minimum between contacts for SB220s & SB60s for 1 minute minimum; 1,500V AC minimum between contacts & case for SB220s & SB60s for 1 minute minimum
Mechanical Life:	50,000 operations minimum for SB220s; 30,000 operations minimum for SB25s, SB60s, SB265s, SB285
Electrical Life:	10,000 operations minimum
Total Travel:	SB220s .116" (2.95mm); SB60s .094" (2.4mm); SB265 .213" (5.4mm); SB285 & SB25s .195" (4.95mm)
Operating Temp Range:	-10°C through +70°C (+14°F through +158°F)

Materials & Finishes

Cap:	Polybutylene terephthalate (PBT) (AT414)
Plunger:	Polyacetal or brass with nickel plating
Bushing:	Brass with nickel plating
Case:	Phenolic resin or melamine phenolic resin
Case Cover:	Steel with zinc plating
Movable & Stationary Contacts:	Copper with silver plating for SB220s; silver alloy with silver plating for SB25s, SB60s, & SB200s
Terminals:	Copper with tin plating for SB25s & SB60s; copper with silver plating for SB200s

Standards & Certifications



UL Recognized: Designated with UL recognized symbol beside part numbers on following pages
See Supplement Index (page Z2) to find UL rating details. UL File No. WOYR2.E44145
Add "/U" to end of part number to order UL mark on switch.



CSA Certified: Designated with CSA certified symbol beside part numbers on following pages
See Supplement section to find UL rating details. CSA File No. 023535-0-000
Add "/C" to end of part number to order CSA mark on switch.

SINGLE POLE WITH SOLDER LUG OR SCREW LUG

Model	Approvals	Pole & Throw	Pushbutton Position/Connected Terminals () = Momentary			Electrical Capacity (Resistive)	
			Normal	Keyway	Down	AC 125V	AC 250V
SB221NO	— —	SPST	OFF	—	(ON) 1-4	3A	1.5A
SB221NC		SPST	ON	1-4	(OFF) —	3A	1.5A
SB221TNO*	— —	SPST	OFF	—	(ON) 1-4	3A	1.5A
SB221TNC*		SPST	ON	1-4	(OFF) —	3A	1.5A

* Suffix T = Screw Lug

Throw & Schematic:

SPST
SB221NO



SPST
SB221NC

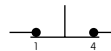

Note: Terminal numbers are actually on the switch.

- Standard Hardware: AT504M Knurled Nut, AT508 Lockwasher, AT527M Hex Backup Nut. See Accessories & Hardware section for details.
- Solder lug terminal hole accommodates one 12-gauge solid or stranded wire.

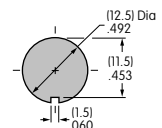
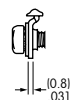
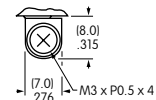
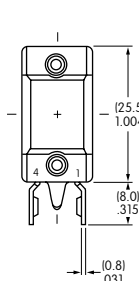
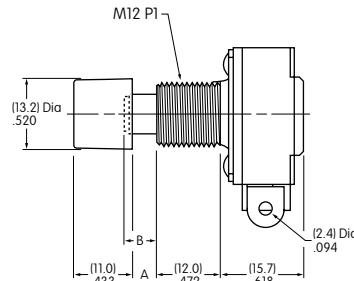
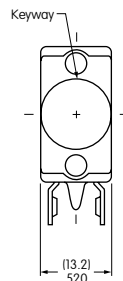





SB221NO
Supplied w/AT414 Black Cap

Dimension A: .185" (4.7mm) for NO model & .150" (3.8mm) for NC model.
Dimension B Plunger Extension: .197" (5.0mm) for NO model & .161" (4.1mm) for NC model.

Panel Thickness
.193" (4.9mm)

DOUBLE POLE WITH SOLDER LUG

Model	Approvals	Pole & Throw	Pushbutton Position/Connected Terminals () = Momentary				Electrical Capacity (Resistive)	
			Normal  Keyway	Down 			AC 125V	AC 250V
SB61A	  —	DPDT	ON	2-3 5-6	(ON)	2-1 5-4	10A	5A
SB61B	— — —	DPDT	ON	2-3 5-6	(ON)	2-1 5-4	3A	1.5A
SB63A*	— — —	DPDT	ON	2-3 5-6	(ON) or Lockdown ON	2-1 5-4	10A	5A

* Lockdown for SB63A is achieved by actuating & then turning the button clockwise.

Throw & Schematic:

DPDT

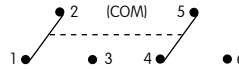

Note: Terminal numbers are actually on the switch.

- Standard Hardware: AT504M Knurled Nut, AT508 Lockwasher, AT527M Hex Backup Nut. See Accessories & Hardware section for details.
- Solder lug terminal hole accommodates one 12-gauge solid or stranded wire.

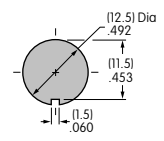
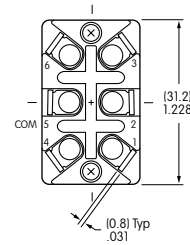
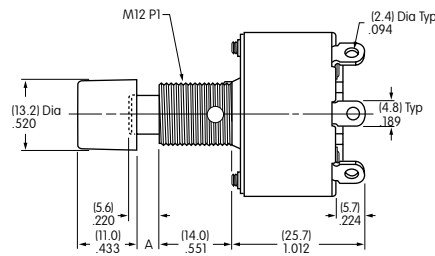
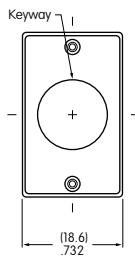





Panel Thickness
.193" (4.9mm)

SB61A

Supplied w/AT414 Black Cap

Dimension A: .169" (4.3mm) for SB61 model & .130" (3.3mm) for SB63 model.

DOUBLE POLE WITH SOLDER LUG

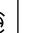
Model	Approvals	Pole & Throw	Pushbutton Position/Connected Terminals () = Momentary				Electrical Capacity (Resistive)	
			Normal  Keyway	Down 			AC 125V	AC 250V
SB25	  	DPDT	ON	2-3 5-6	ON	2-1 5-4	15A	9A

Throw & Schematic:

DPDT

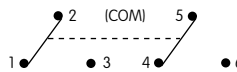

Note: Terminal numbers are actually on the switch.

- Standard Hardware: AT504M Knurled Nut, AT508 Lockwasher, AT527M Hex Backup Nut. See Accessories & Hardware section for details.
- Solder lug terminal hole accommodates one 12-gauge solid or stranded wire.

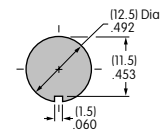
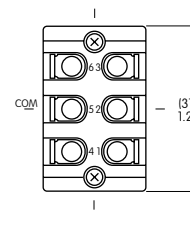
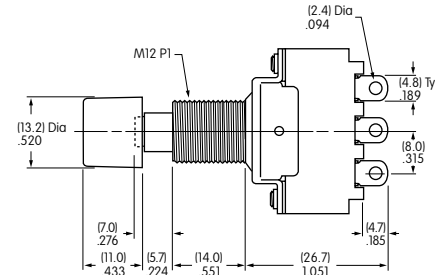
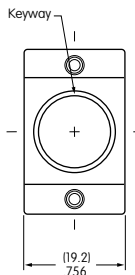





Panel Thickness
.193" (4.9mm)

SB25

Supplied w/AT414 Black Cap

SINGLE POLE WITH SOLDER LUG

Model	Approvals	Pole & Throw	Pushbutton Position/Connected Terminals () = Momentary		Electrical Capacity (Resistive)	
			Normal  Keyway	Down 	AC 125V	AC 250V
SB265	  	SPST	ON 1-4	OFF —	6A	3A

Throw & Schematic:

SPST

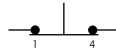

Note: Terminal numbers are actually on the switch.

- Standard Hardware: AT504M Knurled Nut, AT508 Lockwasher, AT527M Hex Backup Nut. See Accessories & Hardware section for details.
- Solder lug terminal hole accommodates one 12-gauge solid or stranded wire.

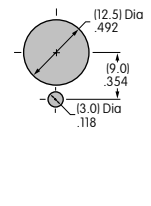
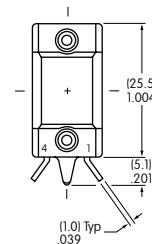
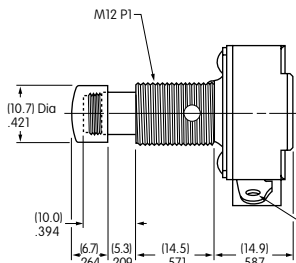
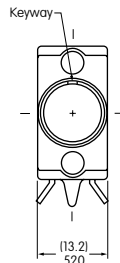





Panel Thickness
.291" (7.4mm)

SB265

Supplied with Chrome Plated Brass Cap

DOUBLE POLE WITH SOLDER LUG

Model	Approvals	Pole & Throw	Pushbutton Position/Connected Terminals () = Momentary		Electrical Capacity (Resistive)	
			Normal  Keyway	Down 	AC 125V	AC 250V
SB285	 	DPDT	ON 2-3 5-6	ON 2-1 5-4	6A	3A

Throw & Schematic:

DPDT

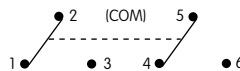

Note: Terminal numbers are actually on the switch.

- Standard Hardware: AT504M Knurled Nut, AT508 Lockwasher, AT527M Hex Backup Nut. See Accessories & Hardware section for details.
- Solder lug terminal hole accommodates one 12-gauge solid or stranded wire.

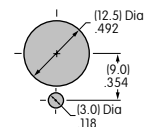
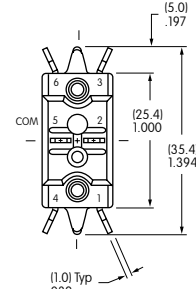
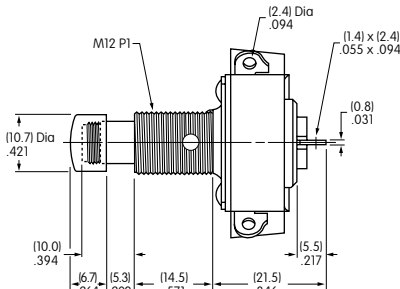
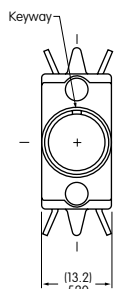

Panel Thickness
.272" (6.9mm)

SB285

Supplied with Chrome Plated Brass Cap

GENERAL SPECIFICATIONS FOR PUSH-PULL PUSHBUTTONS

Electrical Capacity (Resistive & Inductive Load)

Power Level: Shown in the following tables



Other Ratings

Contact Resistance: 10 milliohms maximum
Insulation Resistance: 200 megohms minimum @ 500V DC
Dielectric Strength: 1,500V AC min. for 1 minute min.
Mechanical Life: 30,000 operations minimum
Electrical Life: 10,000 operations minimum
Total Travel: .177" (4.5mm) for SB862;
 .059" (1.5mm) for SB282
Operating Temp Range: -10°C through +70°C
 (+14°F through +158°F)

Materials & Finishes

Plunger: Brass with nickel plating
Bushing: Brass with nickel plating
Case: Phenolic resin
Case Cover: Steel with zinc plating
Movable Contactor: Brass with silver plating - SB862;
 copper with silver plating - SB282
Movable & Stationary Contacts: Silver - SB862;
 copper with silver plating - SB282
Terminals: Brass with silver plating - SB862;
 copper with silver plating - SB282

SINGLE POLE PUSH-PULL WITH SOLDER LUG

Model	Approvals	Pole & Throw	Pushbutton Position/Connected Terminals () = Momentary		Electrical Capacity (Resistive)	
			Normal  Keyway	Down 	AC 125V	AC 250V
SB862	— —	SPST	ON 1-2	OFF —	10A	5A

Throw & Schematic:



Note: Terminal numbers are not on the switch.



- Standard Hardware: AT504M Knurled Nut, AT508 Lockwasher, AT527M Hex Backup Nut. See Accessories & Hardware section for details.
- Solder lug terminal hole accommodates one 12-gauge solid or stranded wire.

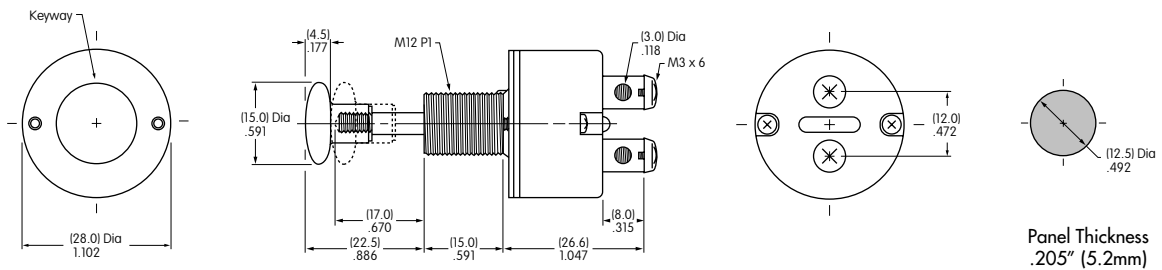

SB862
 Supplied with Black Knob AT424A



DOUBLE POLE PUSH-PULL WITH SOLDER LUG

Model	Approvals	Pole & Throw	Pushbutton Position/Connected Terminals () = Momentary		Electrical Capacity (Resistive)	
			Normal  Keyway	Down 	AC 125V	AC 250V
SB282	— —	DPDT	ON 2-1 5-4	ON 2-3 5-6	6A	3A

Throw & Schematic:



Note: Terminal numbers are actually on the switch.

- Standard Hardware: AT504M Knurled Nut, AT508 Lockwasher, AT527M Hex Backup Nut. See Accessories & Hardware section for details.
- Solder lug terminal hole accommodates one 12-gauge solid or stranded wire.



SB282
 Supplied with Black Knob AT423A;
 Red Knob AT423C
 Available on Request

